

# Avdel® SR SR01



For installation information please refer to the tooling overview and manuals on our website [www.avdel-global.com](http://www.avdel-global.com).  
 Pour les conditions de pose, merci de vous référer à la description de l'outil et aux manuels disponibles sur notre site Web.  
 Angaben zur Verbeitung entnehmen Sie bitte der Geräteübersicht und den Betriebsanleitungen auf unserer Website.  
 Per informazioni sull'installazione preghiamo consultare i manuali e la panoramica degli attrezzi sul nostro sito web.  
 Para ver información sobre máquinas de colocación, consulte nuestra página web, a partir de visión general de máquinas y manuales.

English	Français	Deutsch	Italiano	Español
Dome head	Tête plate	Flachrundkopf	Testa tonda	Cabeza alomada
Body: Aluminium alloy* Polished	Corps: Alliage d'aluminium* Poli	Hülse: Aluminium* Blank	Corpo: Lega di alluminio* Lucido	Cuerpo: Aluminio* Pulido
Stem: Steel Phosphated	Tige: Acier Phosphaté	Dorn: Stahl Phosphatiert	Gambo: Acciaio Fosfatato	Vástago: Acero Fosfatado

\*: ALMg5

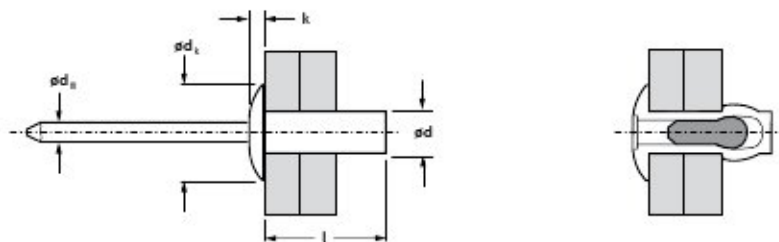

$\varnothing$ nom.				$\varnothing d$	$l$ +1.0 -0.2	$\varnothing d_k$	$k$ max.	$\varnothing d_m$			Part No/ref
	min.	max.									
3.2 (1/8")	0.5	2.0	3.3	3.2 [±0.08]	6.5	6.0 [±0.24]	1.4	1.7	1.07	1.25	OSR01-03265
	2.0	3.5									OSR01-03280
	3.5	5.0									OSR01-03295
	5.0	6.5									OSR01-03211
	6.5	8.0									OSR01-03212
4.0 (5/32")	0.5	3.5	4.1	4.0 [±0.08]	8.0	8.0 [±0.29]	1.7	2.18	1.70	2.24	OSR01-04080
	3.5	4.5									OSR01-04095
	4.5	6.5									OSR01-04011
	6.5	8.0									OSR01-04012
	8.0	10.5									OSR01-04014
4.8 (3/16")	1.0	3.0	4.9	4.8 [±0.08]	8.0	9.5 [±0.29]	2.0	2.63	2.20	3.10	OSR01-04880
	3.0	4.5									OSR01-04895
	4.5	6.0									OSR01-04811
	6.0	7.5									OSR01-04812
	7.5	9.0									OSR01-04814
	9.0	11.0									OSR01-04816
	11.0	13.0									OSR01-04818
	13.0	16.0									OSR01-04821
	16.0	20.0									OSR01-04825
6.4 (1/4")	1.5	6.0	6.5	6.4 [±0.11]	12.5	12.7 [±0.35]	2.5	3.7	3.95	4.90	OSR01-06412
	6.0	8.0									OSR01-06416

all dimensions in mm / en millimètre / alle Maße in mm / in millimetri / en milímetros

Avdel - Partner seit 1986



An Acument™ Global Technologies Company

[www.avdel-global.com](http://www.avdel-global.com)

Avdel® is a trademark of Avdel UK Limited

Data shown is subject to change without prior notice as a result of continuous product development.  
 Your local Avdel representative is at your disposal should you need to confirm latest information.



# Avdel® SR SR02





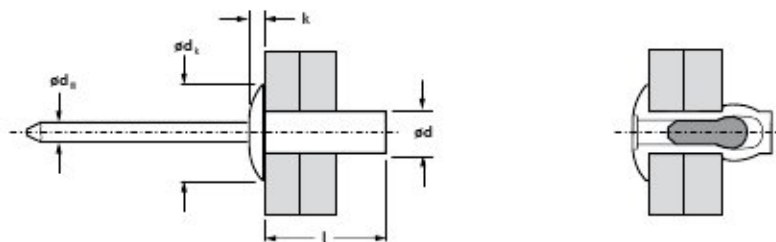

For installation information please refer to the tooling overview and manuals on our website [www.avdel-global.com](http://www.avdel-global.com).  
 Pour les conditions de pose, merci de vous référer à la description de l'outil et aux manuels disponibles sur notre site Web.  
 Angaben zur Verarbeitungs entnehmen Sie bitte der Geräteübersicht und den Betriebsanleitungen auf unserer Website.  
 Per informazioni sull'installazione preghiamo consultare i manuali e la panoramica degli attrezzi sul nostro sito web.  
 Para ver información sobre máquinas de colocación, consulte nuestra página web, a partir de visión general de máquinas y manuales.

English	Français	Deutsch	Italiano	Español
Dome head	Tête plate	Flachrundkopf	Testa tonda	Cabeza alomada
Body: Aluminium alloy*	Corps: Alliage d'aluminium*	Hülse: Aluminium*	Corpo: Lega di alluminio*	Cuerpo: Aluminio*
Polished	Poli	Blank	Lucido	Pulido
Stem: Stainless steel**	Tige: Inox**	Dorn: Edelstahl**	Gambo: Acciaio inox**	Vástago: Acero inoxidable**
Polished	Poli	Blank	Lucido	pulido

\*: AlMg5  
 \*\*: A2

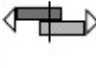

ø nom.				ød ±0.08	l +1.0 -0.2	ødk	k max.	ødm	 kN	 kN	Part No/ref
	min.	max.									
3.2 (1/8")	0.5	2.0	3.3	3.2	6.5	6.0 [±0.24]	1.4	1.7	1.07	1.25	0SR02-03265
	2.0	3.5			8.0						0SR02-03280
	3.5	5.0			9.5						0SR02-03295
	5.0	6.5			11.0						0SR02-03211
	6.5	8.0			12.7						0SR02-03212
4.0 (5/32")	0.5	3.5	4.1	4.0	8.0	8.0 [±0.29]	1.7	2.18	1.70	2.24	0SR02-04080
	3.5	4.5			9.5						0SR02-04095
	4.5	6.5			11.0						0SR02-04011
	6.5	8.0			12.7						0SR02-04012
4.8 (3/16")	1.0	3.0	4.9	4.8	8.0	9.5 [±0.29]	2.0	2.63	2.20	3.10	0SR02-04880
	3.0	4.5			9.5						0SR02-04895
	4.5	6.0			11.0						0SR02-04811
	6.0	7.5			12.5						0SR02-04812
	7.5	9.0			14.0						0SR02-04814
	9.0	11.0			16.0						0SR02-04816
	11.0	13.0			18.0						0SR02-04818
	13.0	16.0			21.0						0SR02-04821

all dimensions in mm / en millimètre / alle Maße in mm / in millimetri / en milímetros

Avdel - Partner seit 1986



An Acument™ Global Technologies Company

[www.avdel-global.com](http://www.avdel-global.com)

© 2009 Acument Intellectual Properties, LLC

Avdel® is a trademark of Avdel UK Limited

02.2009

Data shown is subject to change without prior notice as a result of continuous product development and improvement policy.  
 Your local Avdel representative is at your disposal should you need to confirm latest information.

# Avdel® SR SR03



For installation information please refer to the tooling overview and manuals on our website [www.avdel-global.com](http://www.avdel-global.com).  
 Pour les conditions de pose, merci de vous référer à la description de l'outil et aux manuels disponibles sur notre site Web.  
 Angaben zur Verarbeitungs entnehmen Sie bitte der Geräteübersicht und den Betriebsanleitungen auf unserer Website.  
 Per informazioni sull'installazione, preghiamo consultare i manuali e la panoramica degli attrezzi sul nostro sito web.  
 Para ver información sobre máquinas de colocación, consulte nuestra página web, a partir de visión general de máquinas y manuales.

English	Français	Deutsch	Italiano	Español
Dome head	Tête plate	Flachrundkopf	Testa tonda	Cabeza alomada
Body: Copper Polished	Corps: Cuivre Poli	Hülse: Kupfer Blank	Corpo: Rame Lucido	Cuerpo: Cobre Pulido
Stem: Steel	Tige: Acier	Dorn: Stahl	Gambo: Acciaio	Vástago: Acero
Protection layer	Couche protectrice	Schutzschicht	Strato protettivo	Coupa protectora

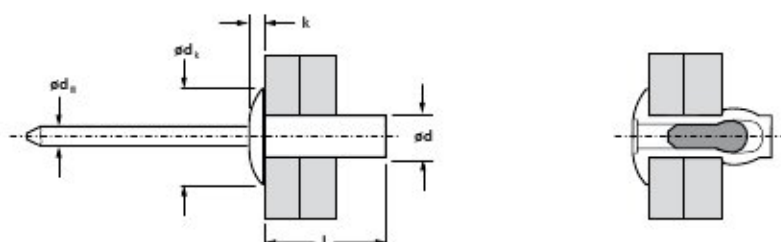

ø nom.				ød +0.08 -0.1	l +1.0 -0.2	ødk 6.0 [±0.24]	k max. 1.4	ødm 1.7	 kN 0.85	 kN 1.3	Part No/ref
	min.	max.									
3.2 (1/8")	0.5	1.5	3.3	3.2	6.5	6.0 [±0.24]	1.4	1.7	0.85	1.3	0SR03-03265
	1.5	3.0			8.0						0SR03-03280
	2.5	4.5			9.5						0SR03-03295
	4.5	7.5			12.5						0SR03-03212
4.0 (5/32")	0.5	2.0	4.1	4.0	8.0	8.0 [±0.29]	1.7	2.18	1.35	2.0	0SR03-04080
	2.0	4.0			10.0						0SR03-04010
4.8 (3/16")	1.0	2.5	4.9	4.8	9.5	9.5 [±0.29]	2.0	2.63	1.95	2.8	0SR03-04895
	2.5	4.5			11.5						0SR03-04811

all dimensions in mm / en millimètre / alle Maße in mm / in millimetri / en milímetros



An Acument™ Global Technologies Company

[www.avdel-global.com](http://www.avdel-global.com)

Avdel® is a trademark of Avdel UK Limited

Avdel - Partner seit 1986



© 2009 Acument Intellectual Properties, LLC

02.2009

Data shown is subject to change without prior notice as a result of continuous product development and improvement policy.  
 Your local Avdel representative is at your disposal should you need to confirm latest information.

# Avdel® SR SR04





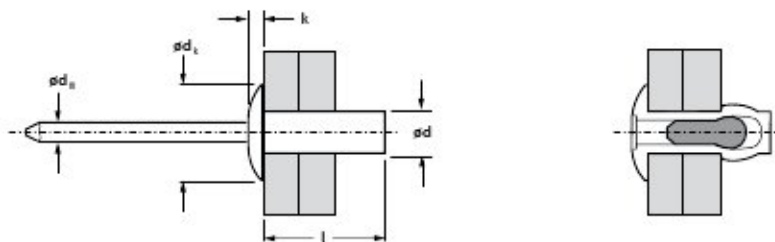

For installation information please refer to the tooling overview and manuals on our website [www.avdel-global.com](http://www.avdel-global.com).  
 Pour les conditions de pose, merci de vous référer à la description de l'outil et aux manuels disponibles sur notre site Web.  
 Angaben zur Verarbeitungs entnehmen Sie bitte der Geräteübersicht und den Betriebsanleitungen auf unserer Website.  
 Per informazioni sull'installazione, preghiamo consultare i manuali e la panoramica degli attrezzi sul nostro sito web.  
 Para ver información sobre máquinas de colocación, consulte nuestra página web, a partir de visión general de máquinas y manuales.

English	Français	Deutsch	Italiano	Español
Dome head	Tête plate	Flachrundkopf	Testa tonda	Cabeza alomada
Body: Aluminium alloy* Polished	Corps: Alliage d'aluminium* Poli	Hülse: Aluminium* Blank	Corpo: Lega di alluminio* Lucido	Cuerpo: Aluminio* Pulido
Stem: Aluminium alloy Polished	Tige: Alliage d'aluminium Poli	Dorn: Aluminium Blank	Gambo: Lega di alluminio Lucido	Vástago: Aluminio Pulido

\*: Al99,5

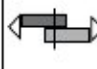

ø nom.				ød ±0.08	l +1.0 -0.2	ødk [±0.24]	k max.	ødm	 kN	 kN	Part No/ref
	min.	max.									
3.2 (1/8")	0.5	3.5	3.3	3.2	8.0	6.0 [±0.24]	1.4	1.8	0.45	0.49	0SR04-03280
	3.5	5.5			9.5						0SR04-03295
4.0 (5/32")	0.5	5.0	4.1	4.0	9.5	8.0 [±0.29]	1.7	2.2	0.58	0.82	0SR04-04095
	5.0	8.0			12.5						0SR04-04012
4.8 (3/16")	1.0	4.5	4.9	4.8	9.5	9.5 [±0.29]	2.0	2.65	0.90	1.12	0SR04-04895
	4.5	6.5			11.5						0SR04-04811
	6.5	9.5			14.5						0SR04-04814
	9.5	13.0			18.0						0SR04-04818

all dimensions in mm / en millimètre / alle Maße in mm / in millimetri / en milímetros

# Avdel® SR SR21

For installation information please refer to the tooling overview and manuals on our website [www.avdel-global.com](http://www.avdel-global.com).  
 Pour les conditions de pose, merci de vous référer à la description de l'outil et aux manuels disponibles sur notre site Web.  
 Angaben zur Verarbeitungs entnehmen Sie bitte der Geräteübersicht und den Betriebsanleitungen auf unserer Website.  
 Per informazioni sull'installazione, preghiamo consultare i manuali e la panoramica degli attrezzi sul nostro sito web.  
 Para ver información sobre máquinas de colocación, consulte nuestra página web, a partir de visión general de máquinas y manuales.

English	Français	Deutsch	Italiano	Español
120° Countersunk head	120° Tête fraisée	120° Senkkopf	120° Testa svasata	120° Cabeza avellanada
Body: Aluminium alloy* Polished	Corps: Alliage d'aluminium* Poli	Hülse: Aluminium* Blank	Corpo: Lega di alluminio* Lucido	Cuerpo: Aluminio* Pulido
Stem: Steel Phosphated	Tige: Acier Phosphaté	Dorn: Stahl Phosphatiert	Gambo: Acciaio Fosfatato	Vástago: Acero Fosfatado

\*: ALMg5

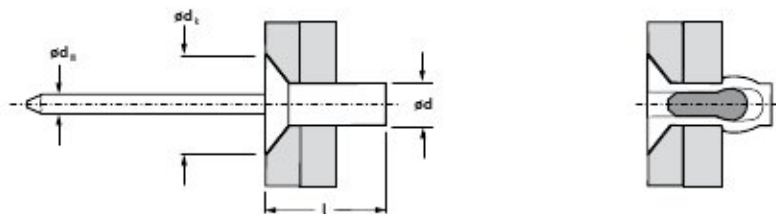

ø nom.				ød ±0.8	l +1.0 -0.2	ød <sub>k</sub>	ød <sub>m</sub>	 kN	 kN	Part No/ref
	min.	max.								
3.2 (1/8")	1.5	3.5	3.3	3.2	7.5	6.0 [-0.4]	1.7	1.07	1.245	0SR21-03275
	3.0	5.0			9.0					0SR21-03290
	4.5	6.5			10.5					0SR21-03210
4.0 (5/32")	3.0	5.0	4.1	4.0	9.5	7.5 [-0.5]	2.2	1.71	2.24	0SR21-04095
	4.5	6.5			11.0					0SR21-04011
	6.0	8.0			12.5					0SR21-04012
4.8 (3/16")	2.5	4.5	4.9	4.8	9.5	9.0 [-0.5]	2.65	2.23	3.07	0SR21-04810
	4.0	6.0			11.0					0SR21-04811
	5.5	7.5			12.5					0SR21-04812
	7.0	9.0			14.0					0SR21-04814
	8.5	10.5			15.5					0SR21-04815
	12.0	14.0			19.0					0SR21-04819

all dimensions in mm / en millimètre / alle Maße in mm / in millimetri / en milímetros

# Avdel® SR SR31



For installation information please refer to the tooling overview and manuals on our website [www.avdel-global.com](http://www.avdel-global.com).  
 Pour les conditions de pose, merci de vous référer à la description de l'outil et aux manuels disponibles sur notre site Web.  
 Angaben zur Verbeitung entnehmen Sie bitte der Geräteübersicht und den Betriebsanleitungen auf unserer Website.  
 Per informazioni sull'installazione, preghiamo consultare i manuali e la panoramica degli attrezzi sul nostro sito web.  
 Para ver información sobre máquinas de colocación, consulte nuestra página web, a partir de visión general de máquinas y manuales.

English	Français	Deutsch	Italiano	Español
Dome head	Tête plate	Flachrundkopf	Testa tonda	Cabeza alomada
Body: Steel Zinc plated	Corps: Acier Revêtement zingué	Hülse: Stahl Verzinkt	Corpo: Acciaio Zincato	Cuerpo: Acero Zincado
Stem: Steel Zinc plated	Tige: Acier Revêtement zingué	Dorn: Stahl Verzinkt	Gambo: Acciaio Zincato	Vástago: Acero Zincado

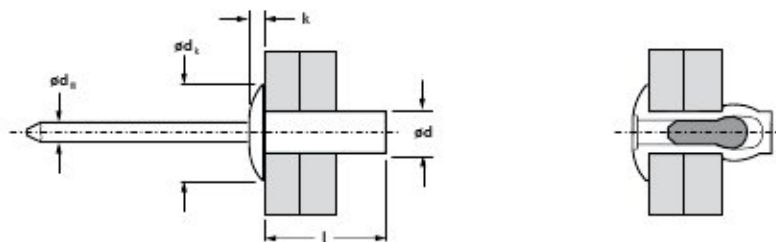

$\varnothing$ nom.				$\varnothing d$	$l$	$\varnothing d_k$	$k$	$\varnothing d_m$			Part No/ref
	min.	max.									
3.2 (1/8")	0.5	1.5	3.3	3.2	6.0	6.0 [ $\pm 0.24$ ]	1.0	1.9	1.6	2.2	0SR31-03260
	1.5	3.0			8.0						0SR31-03280
	3.0	5.0			9.5						0SR31-03295
	5.0	7.0			12.0						0SR31-03212
4.0 (5/32")	0.5	1.5	4.1	4.0	6.0	8.0 [ $\pm 0.29$ ]	1.4	2.3	2.3	2.5	0SR31-04060
	1.5	3.0			8.0						0SR31-04080
	3.0	5.0			10.0						0SR31-04010
	5.0	6.5			12.0						0SR31-04012
	6.5	10.5			15.0						0SR31-04015
4.8 (3/16")	1.0	3.0	4.9	4.8	8.0	9.5 [ $\pm 0.29$ ]	1.7	2.9	2.9	3.8	0SR31-04880
	3.0	5.0			9.5						0SR31-04810
	5.0	6.5			12.0						0SR31-04812
	6.5	10.5			16.0						0SR31-04816

all dimensions in mm / en millimètre / alle Maße in mm / in millimetri / en milímetros



An Acument™ Global Technologies Company

[www.avdel-global.com](http://www.avdel-global.com)

Avdel® is a trademark of Avdel UK Limited

Avdel - Partner seit 1986



© 2009 Acument Intellectual Properties, LLC

02.2009

Data shown is subject to change without prior notice as a result of continuous product development and improvement policy.  
 Your local Avdel representative is at your disposal should you need to confirm latest information.

# Avdel® SR SR41





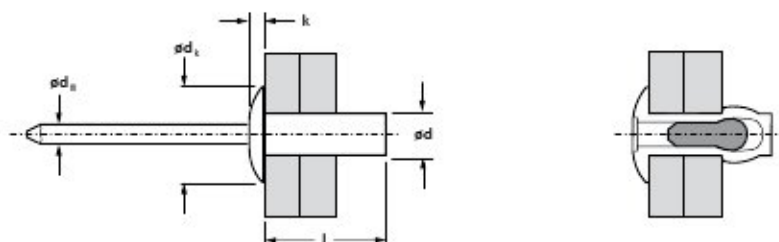

For installation information please refer to the tooling overview and manuals on our website [www.avdel-global.com](http://www.avdel-global.com).  
 Pour les conditions de pose, merci de vous référer à la description de l'outil et aux manuels disponibles sur notre site Web.  
 Angaben zur Verbeitung entnehmen Sie bitte der Geräteübersicht und den Betriebsanleitungen auf unserer Website.  
 Per informazioni sull'installazione, preghiamo consultare i manuali e la panoramica degli attrezzi sul nostro sito web.  
 Para ver información sobre máquinas de colocación, consulte nuestra página web, a partir de visión general de máquinas y manuales.

English	Français	Deutsch	Italiano	Español
Dome head	Tête plate	Flachrundkopf	Testa tonda	Cabeza alomada
Body: Stainless steel* Polished	Corps: Inox* Poli	Hülse: Edelstahl* Blank	Corpo: Acciaio inox* Lucido	Cuerpo: Acero inoxidable* Pulido
Stem: Stainless steel* Polished	Tige: Inox* Poli	Dorn: Edelstahl* Blank	Gambo: Acciaio inox* Lucido	Vástago: Acero inoxidable* Pulido

\*: A2

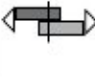

ø nom.				ød	l	ødk	k	ødm	 kN	 kN	Part No/ref
	min.	max.									
3.2 (1/8")	0.5	1.5	3.3	3.2	6.0	6.0 [±0.24]	1.4	1.9	2.0	2.5	0SR41-03260
	1.5	3.0			8.0						0SR41-03280
	3.0	5.0			9.5						0SR41-03210
	5.0	7.0			12.0						0SR41-03212
4.0 (5/32")	0.5	1.5	4.1	4.0	6.0	8.0 [±0.29]	1.7	2.3	3.0	4.0	0SR41-04060
	1.5	3.0			8.0						0SR41-04080
	3.0	5.0			9.5						0SR41-04010
	5.0	6.5			12.0						0SR41-04012
	6.5	10.5			16.0						0SR41-04016
4.8 (3/16")	1.0	3.0	4.9	4.8	8.0	9.5 [±0.29]	2.0	2.9	4.5	5.5	0SR41-04880
	3.0	5.0			9.5						0SR41-04895
	5.0	6.5			12.0						0SR41-04812
	6.5	10.5			16.0						0SR41-04816
	10.5	14.0			20.0						0SR41-04820

all dimensions in mm / en millimètre / alle Maße in mm / in millimetri / en milímetros



An Acument™ Global Technologies Company

[www.avdel-global.com](http://www.avdel-global.com)

Avdel® is a trademark of Avdel UK Limited

Avdel - Partner seit 1986



© 2009 Acument Intellectual Properties, LLC

02.2009

Data shown is subject to change without prior notice as a result of continuous product development and improvement policy.  
 Your local Avdel representative is at your disposal should you need to confirm latest information.